



Head Office:
 A-11,4th Floor
 Malad Yojana CHS LTD,
 S.V Road, Malad (W),
Mumbai- 400 064.
 Tel.: +91 22 2888 3000
 2888 3002
 3222 7830
 Tel.Fax: +91 22 3222 7830
 Email: info@awcindia.in
 Website :www.awcindia.in

Factory Address:
 Plot No.2616, New GIDC,
 Opp. Weighing Scale, Umbergaon,
 Dist: Valsad, Gujarat-396171.
 Tel.: +0260 3193000
 Email: factory@awcindia.in

WALLMATE

- Single Component
- No Solvents
- High Resin Contents
- Uniform High Film Build
- Self Cleaning
- Elastomeric
- Low Temperature Performance
- Abrasive Weather Conditions

PREPARATORY STEPS BEFORE WALLMATE APPLICATION

① STRUCTURAL REPAIR ACTIVITY

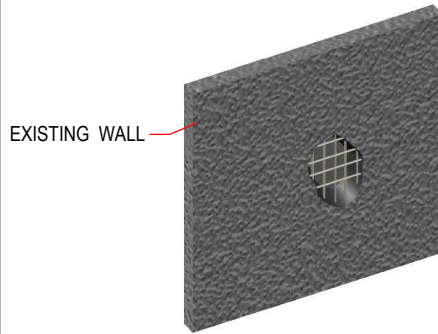

EXISTING WALL

② CRACK REPAIR ACTIVITY

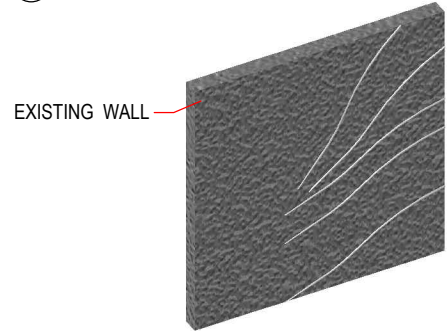

EXISTING WALL

③ PLASTERING ACTIVITY

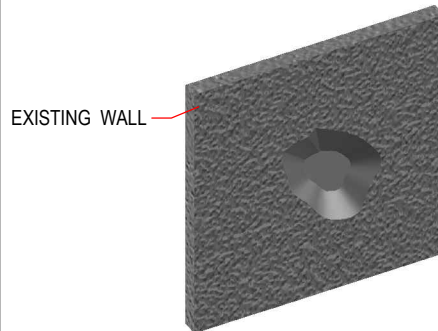

EXISTING WALL

④ DUST CLEANING ACTIVITY

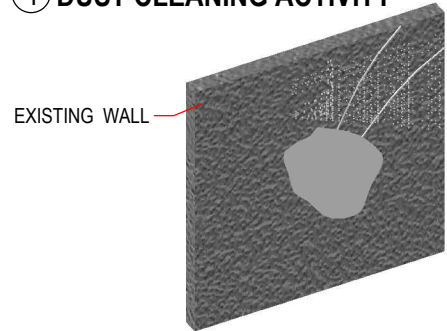

EXISTING WALL

Title: WALLMATE COATING DETAILS
 Version: Revised Date: Date:20/03/2015



Head Office:
 A-11,4th Floor
 Malad Yojana CHS LTD,
 S.V Road, Malad (W),
Mumbai- 400 064.
 Tel.: +91 22 2888 3000
 2888 3002
 3222 7830
 Tel.Fax: +91 22 3222 7830
 Email: info@awcindia.in
 Website :www.awcindia.in

Factory Address:
 Plot No.2616, New GIDC,
 Opp. Weighing Scale, Umbergaon,
 Dist: Valsad, Gujarat-396171.
 Tel.: +0260 3193000
 Email: factory@awcindia.in

WALLMATE

- Single Component
- No Solvents
- High Resin Contents
- Uniform High Film Build
- Self Cleaning
- Elastomeric
- Low Temperature Performance
- Abrasive Weather Conditions

WALLMATE APPLICATIONS

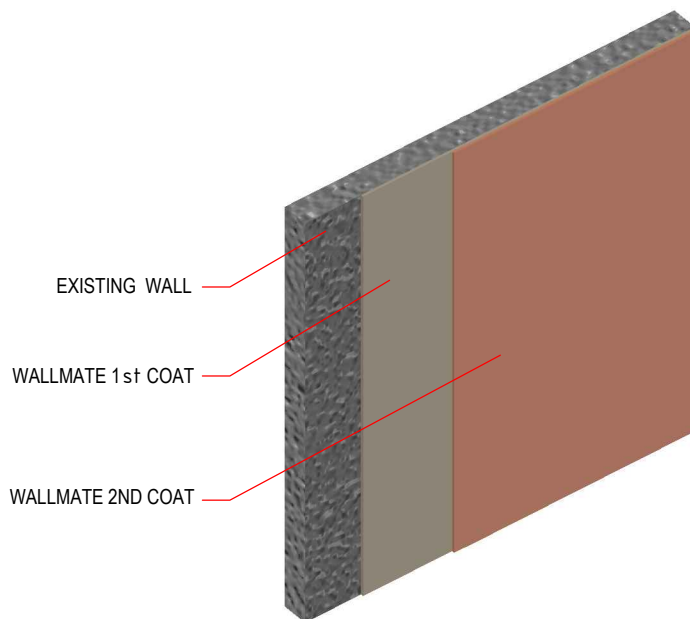

EXISTING WALL

WALLMATE 1st COAT

WALLMATE 2ND COAT

Title: WALLMATE COATING DETAILS
 Version: Revised Date: Date:20/03/2015